

**PRIDE**  
MOBILITY  
LIVE YOUR BEST®

POWER CHAIR COLLECTION







3  
Jazzy Air® 2

4-5  
Go Chair® / Jazzy® Passport

6-7  
Jazzy Select® / Select 6

8-9  
Jazzy® Elite ES / Elite ES Portable

10-11  
Jazzy® Elite 14 / 600 ES

12-13  
Jazzy® Elite ES-1 / Elite HD

14-15  
Jazzy® 614 HD / 1450

16-17  
Accessories / Technology

18-19  
Specifications

Up To  
**19.2**  
Miles Per Charge

**24.25"**  
Turning Radius

Up To  
**4 mph**  
Maximum Speed  
Elevated and Non-Elevated

**300lbs.**  
Weight Capacity



**Jazzy**  
**air<sub>2</sub>**

Press, elevate and go!  
The Jazzy Air® 2 elevates 12 inches at the touch of a button. Feel empowered with this sleek technology that allows you to be face to face with your loved ones. Drive at 4 mph while elevated. It's the future of mobility, and the future is yours.



Silver

Pearl White

Ruby Red

Onyx Black

Pink Topaz

Sapphire Blue

Citrine Yellow

Garnet Red  
(matte)

Tanzanite  
(matte)

Black Pearl  
(matte)



# GOCHAIR®

Compact. Bold. Endless possibilities. The Go Chair® is #1 for portability for easy disassembly in your fast-paced world. Enjoy under seat storage and complete comfort. Choose from six gorgeous colors and let your personality shine through.



Up To  
**13.2**  
Miles Per Charge at 200 lbs.

**25.5"**  
Turning Radius

Up To  
**3.7mph**  
Maximum Speed

**300lbs.**  
Weight Capacity

Up To  
**11**  
Miles Per Charge at 200 lbs.

**24.25"**  
Turning Radius

Up To  
**3.6mph**  
Maximum Speed

**250lbs.**  
Weight Capacity



# Jazzy® PASSPORT

Your destination awaits! Whether you are an avid jet setter to remote areas, or a train commuter to the big city, the Jazzy® Passport folds and unfolds in just a few steps. Compact and lightweight for hassle-free travel, enjoy abundant storage and comfortable seating.

Ruby Red

Pearl White

Amber Orange

Citrine Yellow

Rose Quartz

Sapphire Blue



Black



# Jazzy<sup>®</sup> SELECT

Access your world with ease with the Jazzy Select<sup>®</sup>, a simple yet powerful choice, with a tight turning radius and smooth ride. Maneuver through your home effortlessly with the intuitive controller. Stay mobile and comfortable all day, every day.



Up To  
**19.4**  
Miles Per Charge

**22.5"**  
Turning Radius

Up To  
**4.3mph**  
Maximum Speed

**300lbs.**  
Weight Capacity

Up To  
**15**  
Miles Per Charge

**21.875"**  
Turning Radius

Up To  
**4mph**  
Maximum Speed

**300lbs.**  
Weight Capacity



# Jazzy<sup>®</sup> SELECT 6

Sporty. Sophisticated. Unique. The Jazzy Select<sup>®</sup> 6 offers superior suspension for powerful performance and stability. Experience a tight turning radius and a depth-adjustable seat. Life can be complicated, yet the Jazzy Select 6 is simple.

Jazzy Red

Jazzy Red

Jazzy Blue

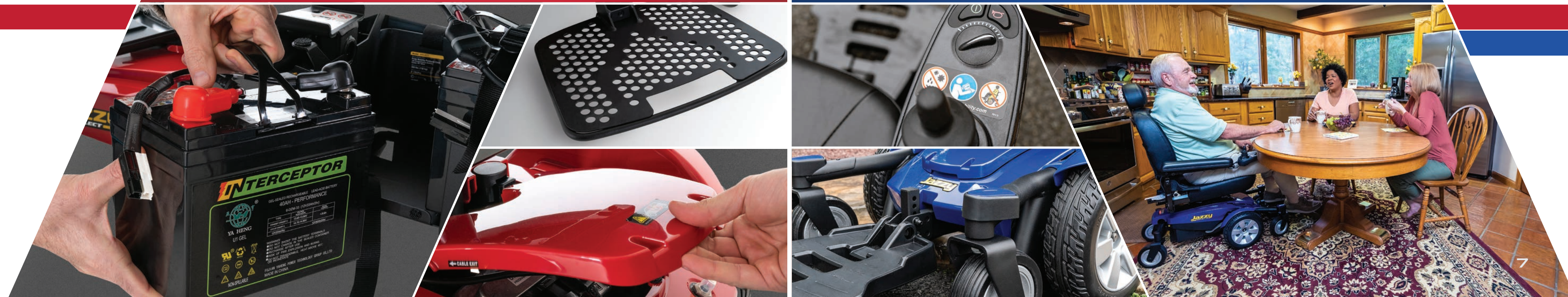





An experience so superior, it can only be elite. The Jazzy® Elite ES features large, front-drive wheels to absorb the bumps and uneven surfaces of everyday life. The comfortable, high-back seat gives you the support you need all day, every day.



Up To  
**13.5**  
Miles Per Charge

**24.75"**  
Turning Radius

Up To  
**4mph**

**300lbs.**  
Weight Capacity

Up To  
**11**  
Miles Per Charge

**25.5"**  
Turning Radius

Up To  
**4mph**

**300lbs.**  
Weight Capacity



Style and performance meet perfect portability. The Jazzy® Elite ES Portable easily disassembles for transport and features large, front wheels to absorb everyday obstacles. An intuitive hand control and a comfortable, high-back seat add to the sophisticated appeal.

Candy Apple Red

Viper Blue



Candy Apple Red

Viper Blue



# Jazzy

ELITE 14

An elite design delivers elite performance. The Jazzy® Elite 14 features front-wheel drive for the tightest turns. Large drive wheels provide superior climbing power over life's obstacles. A high-back seat ensures absolute comfort all day.



Up To  
**9.8**  
Miles Per Charge

**24"**  
Turning Radius

Up To  
**4mph**

**300lbs.**  
Weight Capacity

# Jazzy

600 ES

Life may be complicated, yet your power chair should be simple. The Jazzy® 600 ES has 14-inch drive wheels and independent front casters that handle terrain changes easily. Enjoy aggressive precision, a tight turning radius and a flawless design.



Up To  
**17**  
Miles Per Charge

**20.5"**  
Turning Radius

Up To  
**4mph**

**300lbs.**  
Weight Capacity

Jazzy Red

Jazzy Blue

Cardinal Red





# Jazzy

ELITE ES-1

The sleek and elegant Jazzy® Elite ES-1 delivers high-class maneuvering with front-wheel drive technology. Enjoy effortless controls and a comfortable, high-back seat on this power chair. Choose Jazzy every time.



Up To  
**12**  
Miles Per Charge

**23.5"**  
Turning Radius

Up To  
**4mph**  
Maximum Speed

**300lbs.**  
Weight Capacity

Candy Apple Red

Viper Blue

# Jazzy

ELITE HD

Experience the power and versatility of the Jazzy® Elite HD. Large front wheels absorb and climb, easily tackling life's everyday obstacles. An intuitive hand control ensures effortless operation and simple maneuvering.



Up To  
**9.8**  
Miles Per Charge

**24"**  
Turning Radius

Up To  
**4mph**  
Maximum Speed

**450lbs.**  
Weight Capacity

Jazzy Red

Jazzy Blue





**Jazzy**  
614 HD

Power and precision combine into one exceptional power chair! The Jazzy® 614 HD features outstanding suspension and a tight turning radius. Large drive wheels and six-inch casters tackle uneven terrain, no matter where your day takes you.



Up To  
**11**  
Miles Per Charge

**22.75"**  
Turning Radius

Up To  
**4.25mph**

**450lbs.**  
Weight Capacity

Up To  
**15.7**  
Miles Per Charge

**26.5"**  
Turning Radius

Up To  
**4.5mph**

**600lbs.**  
Weight Capacity



**Jazzy**  
1450

With a robust and heavy-duty design, the Jazzy® 1450 ensures powerful performance with front-wheel drive and efficient motors. Knobby drive tires provide the traction you need over uneven terrain. With speeds up to 4.5 mph, live life on your terms.

Candy Apple Red

Viper Blue

Candy Apple Red

Viper Blue





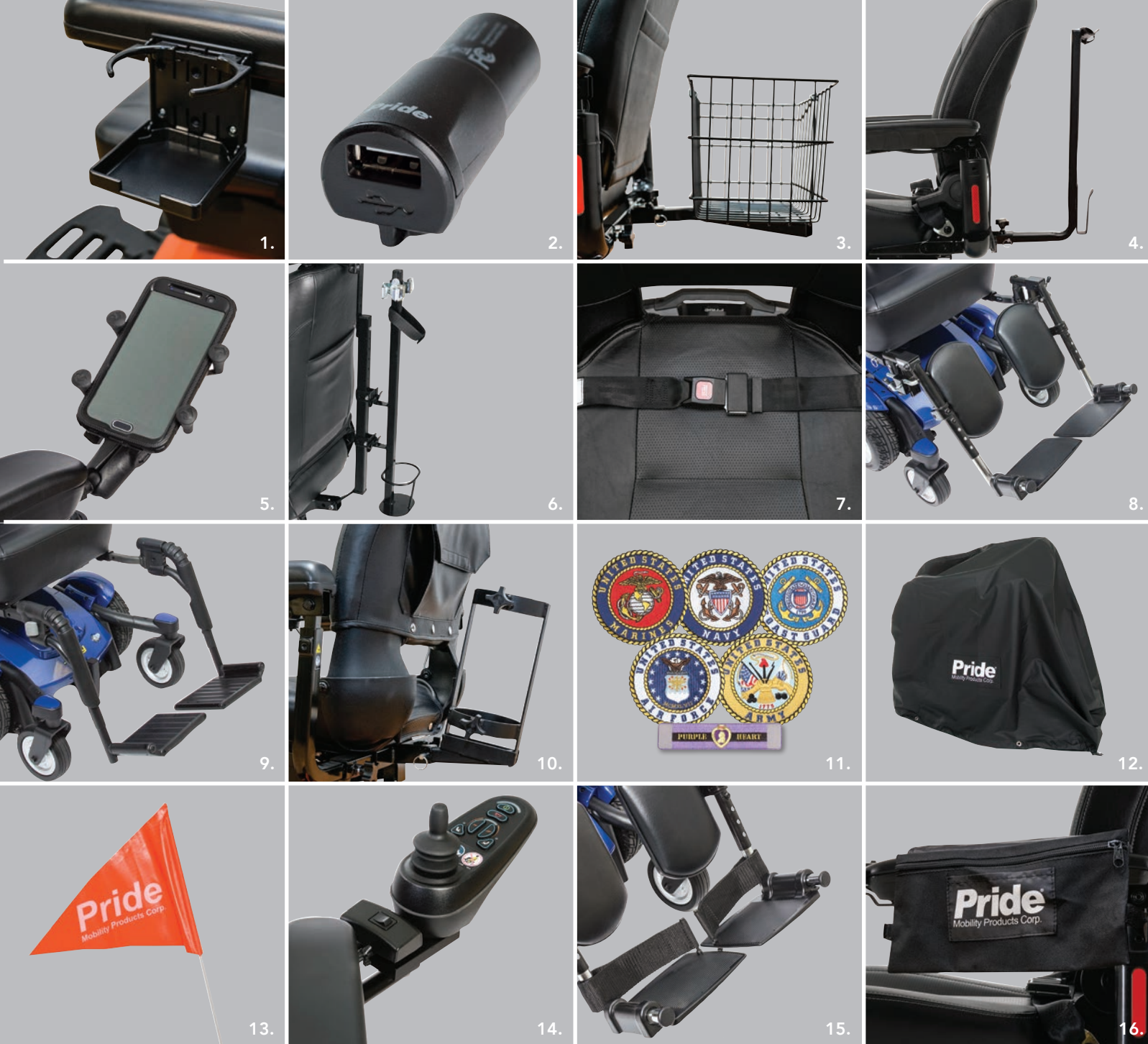

1. Cup Holder | 2. XLR USB Charger | 3. Rear Basket | 4. Walker Holder | 5. Cell Phone Holder | 6. Cane/Crutch Holder  
 7. Lap Belt | 8. Elevating Legrests | 9. Swing-Away Legrests | 10. Oxygen Tank Holder | 11. Military Patches | 12. Weather Cover  
 13. Safety Flag | 14. Swing-Away Joystick | 15. Heel Loops | 16. Saddle Bag

# ACCESSORIES

We take innovation to the next level with a wide variety of technologies and state-of-the-art development.

Mid-Wheel 6® Technology and Active-Trac® ATX Suspension allow the active front casters to lift when climbing a threshold or obstacle, while also dropping down for stability when descending.

In-line motors deliver enhanced torque, battery range and reliability for the most dependable performance.

Power elevated seating on the Jazzy Air® 2 features Extra Stability Technology®, mechanically stabilizing the power base, for ultimate security when driving at 4 mph while elevated.

# INNOVATIVE TECHNOLOGY









	NON-CODED*			CODED		
MODEL NAME	JAZZY AIR® 2	JAZZY® PASSPORT	GO CHAIR®	JAZZY® ELITE ES-1	JAZZY® ELITE ES PORTABLE	JAZZY® ELITE ES
WEIGHT CAPACITY	300 lbs.	250 lbs.	300 lbs.	300 lbs.	300 lbs.	300 lbs.
TURNING RADIUS³	24.25"	24.25"	25.5"	23.5"	25.5"	24.75"
OVERALL LENGTH /WIDTH³	41.93" / 23.19"	40" / 23.5"	28.5" / 22.5"	34.75" / 22.75"	34.75" / 22.75"	34.75" / 22.75"
MAXIMUM SPEED¹	Up to 4 mph (elevated and non-elevated)	Up to 3.6 mph	Up to 3.7 mph	Up to 4 mph	Up to 4 mph	Up to 4 mph
GROUND CLEARANCE³	1"	3"	1.75"	0.75"	1.5"	1.5"
FRONT WHEELS	6" flat free	8" solid casters	6" solid casters	5" solid anti-tips	3" solid anti-tips	3" solid anti-tips
DRIVE WHEELS	10" flat free	12" pneumatic drive	9" solid	9" solid	9" solid	9" solid
REAR WHEELS	6" flat free	N/A	3" solid anti-tips	6" solid casters	6" solid casters	6" solid casters
DRIVETRAIN	Two-motor, Mid-Wheel 6® drive	Two-motor, rear-wheel drive	Two-motor, rear-wheel drive	Two-motor, in-line, front-wheel drive	Two-motor, in-line, front-wheel drive	Two-motor, in-line, front-wheel drive
BRAKING SYSTEM	Regenerative and electro-mechanical	Regenerative and electro-mechanical	Regenerative and electro-mechanical	Regenerative and electro-mechanical	Regenerative and electro-mechanical	Regenerative and electro-mechanical
SUSPENSION	Active-Trac® (ATX) with Mid-Wheel 6® Technology	Limited	Limited	Limited	Limited	Limited
HIGH-BACK SEAT (MAX. SIZE)	20"W x 20"-22"D	N/A	N/A	20" W x 20" D	20" W x 20" D	20" W x 20" D
HIGH-BACK SEAT-TO-FLOOR RANGE	21.25" - 33"	19"	N/A	21.5" - 23.5"	21.5" - 23.5"	21.5" - 23.5"
SYNERGY® SEATING	N/A	N/A	N/A	N/A	N/A	N/A
SYNERGY® SEAT SEAT-TO-FLOOR RANGE	N/A	N/A	N/A	N/A	N/A	N/A
POWER ELEVATING SEAT ⁴	Standard	N/A	N/A	N/A	N/A	N/A
STANDARD ELECTRONICS	40A, PG VR2	50A, PG VSI	40A, PG GC3	40A, PG GC3	40A, PG GC3	40A, PG GC3
BATTERY SIZE⁵	(2) 12 volt, U-1 (std.), 40 AH (optional)	(1) 24V 18 AH lithium ion, (1) 25.2V 10.4 AH lithium ion travel battery	(2) 18 AH	(2) U-1	(2) U-1	(2) U-1
STANDARD BATTERY CHARGER	Off-board, 5 amp	Off-board, 2 amp	Off-board, 2 amp	Off-board, 3.5 amp	Off-board, 3.5 amp	Off-board, 3.5 amp
RANGE PER CHARGE ¹,²	Up to 16.8 miles (U-1) Up to 19.2 miles (40 AH)	Up to 9.6 miles at 250 lbs. (18AH), Up to 5.7 miles at 250 lbs. (10.4 AH) Up to 11 miles at 200 lbs. (18AH) Up to 6.3 miles at 250 lbs. (10.4 AH)	Up to 8.7 miles at 300 lbs. Up to 13.2 miles at 200 lbs.	Up to 12 miles	Up to 11 miles	Up to 13.5 miles
BATTERY WEIGHT⁴	24.5 lbs. each (U-1) 32.5 lbs. each (40 AH)	7 lbs., 5.2 lbs. (travel battery)	14 lbs. each	25 lbs. each	25 lbs. each	25 lbs. each
WEIGHT OF HEAVIEST PIECE³	202 lbs. (with seat)	54 lbs. (unit doesn't disassemble) ⁷	36 lbs.	69 lbs.	48 lbs.	69 lbs.
STANDARD SEAT WEIGHT	41 lbs.	N/A	30 lbs. (compact foldable)	43 lbs. (comfort, high-back)	43 lbs. (comfort, high-back)	43 lbs. (comfort, high-back)
STANDARD SEAT SIZE	16" x 16"-18", 18" x 18" - 20", 20" x 20"-22"	17.5" x 16.5"	18" x 17"	16" x 16"-18", 18" x 18" - 20", 20" x 18"-20"	16" x 16"-18", 18" x 18" - 20", 20" x 18"-20"	16" x 16"-18", 18" x 18" - 20", 20" x 18"-20"
HCPCS CODES	K0899	K0899	K0899	Group 1: Standard K0816	Group 2: Standard, Portable (K0820/K0821)	Group 2: Standard (K0822/K0823)
WARRANTY	Frame: 5-year limited Drive motors: 13-month Electronics: 13-month	Frame: 5-year limited Drive motors: 13-month Electronics: 13-month	Frame: 5-year limited Drive motors: 13-month Electronics: 13-month	Frame: 5-year limited Drive motors: 13-month Electronics: 13-month	Frame: 5-year limited Drive motors: 13-month Electronics: 13-month	Frame: 5-year limited Drive motors: 13-month Electronics: 13-month

CODED						
JAZZY SELECT®	JAZZY SELECT® 6	JAZZY® ELITE 14	JAZZY® 600 ES	JAZZY® ELITE HD	JAZZY® 614 HD	JAZZY® 1450
300 lbs.	300 lbs.	300 lbs.	300 lbs.	450 lbs.	450 lbs.	600 lbs.
22.5"	21.875"	24"	20.5"	24"	22.75"	26.5"
44" / 23.74"	35.375" / 23.5"	35.5" / 24.25"	35.5" / 24.5"	35.5" / 24.25"	35.5" / 25.25"	38.25" / 29.25"
Up to 4.3 mph	Up to 4 mph	Up to 4 mph	Up to 4 mph	Up to 4 mph	Up to 4.25 mph	Up to 4.5 mph
0.75"	1.75"	3"	2.75"	3"	2.25"	1.5"
5" solid anti-tips	6" solid casters	3" solid anti-tips	6" solid OMNI-casters	3" solid anti-tips	6" solid casters	4" solid anti-tips
10" solid	10" solid	14"	14"	14" solid	14"	14" solid
6" solid casters	6" solid casters	6" solid casters	6" solid OMNI-casters	6" solid casters	6" solid casters	9" casters
Two-motor, mid-wheel drive	Two-motor, in-line, mid-wheel drive	Two-motor, front-wheel drive	Two-motor, mid-wheel drive	Two-motor, in-line, front-wheel drive	Two-motor, in-line, Mid-Wheel 6® drive	Two-motor, front-wheel drive
Regenerative and electro-mechanical	Regenerative and electro-mechanical	Regenerative and electro-mechanical	Regenerative and electro-mechanical	Regenerative and electro-mechanical	Regenerative and electro-mechanical	Regenerative and electro-mechanical
Active-Trac® (ATX)	Active-Trac® (ATX)	Limited	Active-Trac® (ATX)	Limited	Active-Trac® (ATX)	Swing Arm
20"W x 20"D	20"W x 20"D	20"W x 20"D	20" W x 20" D	24" W x 24" D	24" W x 24" D	32" W x 28" D
21"- 22"	21.25" - 23.25"	20"- 22"	20.5" - 22.5"	20" - 22"	20.5" - 23.5"	20.5" - 22.5"
20"W x 20"D	20"W x 20"D	20"W x 20"D	20"W x 20"D	24"W x 24"D	24" W x 24" D	32" W x 28" D
17.25" - 19.25"	16.5" - 18.5"	15.75" - 17.75"	17.25" - 19.25"	15.75" - 17.75"	17.75" - 19.75"	17.25" - 19.25"
N/A	Optional	N/A	N/A	N/A	N/A	N/A
40A, PG GC3	40A, PG GC3 ⁸	50A, Dynamic Shark	50A, Dynamic Shark	60A, Dynamic Shark	50A, Dynamic Shark	90A, PG VR2
(2) U-1	(2) U-1	(2) NF-22	(2) NF-22	(2) NF-22	(2) NF-22	(2) Group 24
Off-board, 3.5 amp	Off-board, 3.5 amp	Off-board, 5 amp	Off-board, 5 amp	Off-board, 5 amp	Off-board, 5 amp	Off-board, 8 amp
Up to 19.4 miles	Up to 15 miles	Up to 9.8 miles	Up to 17 miles	Up to 9.8 miles	Up to 11 miles	Up to 15.7 miles
25.2 lbs. each	25 lbs. each	37 lbs. each	37 lbs. each	37 lbs. each	37 lbs. each	52 lbs. each
94 lbs.	100 lbs.	99 lbs.	124 lbs.	99 lbs.	122 lbs.	195 lbs.
51.4 lbs. (comfort, high-back)	43 lbs. (comfort, high-back)	52 lbs. (high-back)	52 lbs. (high-back)	52 lbs. (high-back)	52 lbs. (high-back)	52 lbs. (high-back)
16" x 16"- 18", 18" x 18"- 20", 20" x 18"-20"	16" x 16"- 18", 18" x 18"- 20", 20" x 18"-20"	18" x 18"- 20", 20" x 18"- 20", 22" x 20"-22"	18" x 18" - 20", 20" x 20" - 18"	20" x 18" - 20", 22" x 20" - 22"	20" x 18" - 20", 22" x 20" - 22"	24" x 24"
Group 2: Standard (K0822/K0823)	Group 2: Standard (K0822/K0823)	Group 2: Standard (K0822/K0823)	Group 2: Standard (K0822/K0823)	Group 2: Heavy Duty (K0824/K0825)	Group 2: Heavy Duty (K0824/K0825)	Group 2: Very Heavy Duty (K0826/K0827), Single Power Very Heavy Duty (K0839)
Frame: 5-year limited Drive motors: 13-month Electronics: 13-month	Frame: 5-year limited Drive motors: 13-month Electronics: 13-month	Frame: 5-year limited Drive motors: 13-month Electronics: 13-month	Frame: 5-year limited Drive motors: 13-month Electronics: 13-month	Frame: 5-year limited Drive motors: 13-month Electronics: 13-month Batteries: 13-month	Frame: 5-year limited Drive motors: 13-month Electronics: 13-month	(See Footnote 9 on back page)





(US) 800-800-8586 | (CAN) 888-570-1113 | [pridemobility.com](http://pridemobility.com) |    



Note: Transport of the Jazzy® Passport item on commercial aircraft is subject to federal regulations and airline policy. Please consult your airline prior to your flight to ensure your Jazzy® Passport and its lithium-ion battery are permitted.

- 1 Varies with user weight, terrain type, battery amp-hour (AH), battery charge, battery condition, and tire condition. This specification can be subject to a variance of (+ or -) 10%.
- 2 Tested in accordance with ANSI/RESNA, MC Vol2, Section 4 & ISO 7176-4 standards. Results derived from theoretical calculations based on battery specifications and drive system performance. Test conducted at maximum weight capacity.
- 3 Due to manufacturing tolerances and continual product improvement, this specification can be subject to a variance of (+ or -) 3%.
- 4 Battery weight may vary based on battery manufacturer.
- 5 AGM or gel cell type required.
- 6 Maximum weight capacity is reduced to 400 lbs. (181 kg) on 18" deep seat configurations.
- 7 Seat weight included. Unit does not disassemble.
- 8 40A, PG 6-key VR2 required with power elevating seat option.
- 9 K0826/K0827 Models: Lifetime limited on frame; 13-month limited on electronics; 13-month limited on drive motors  
K0839 Model: Lifetime limited on frame; 2-year limited on electronics; 18-month limited on drive motors
- 10 Not all accessories are available for all products. Please speak with your Provider for details and availability.

NOTE: All specifications subject to change without notice.

The information contained herein is correct at the time of publication; we reserve the right to alter specifications without prior notice. Speed and range vary with user weight, terrain type, battery charge, battery condition and tire pressure. Due to manufacturing tolerances and continual product improvement, length, width, turning radius and ground clearance can be subject to variance of + or - 3 %. Dimensions listed are for power chair only. Overall measurements will vary based on seating and accessory selections.

HCPCS codes provided should not be considered as legal advice and do not guarantee reimbursement. DME providers are responsible for determining appropriate billing codes when submitting for insurance reimbursement.

\*Not coded by DME PDAC.

